



# DSC11

## DRAGSTAR CLASSIC ELEVEN

# PAPER CRAFT

### Assembly Instructions



Thank you for downloading the "DRAGSTAR CLASSIC ELEVEN" paper craft model. By simply following this manual while referring to the names and numbers shown on the parts sheets, you can assemble an authentic-looking replica of the DRAGSTAR CLASSIC ELEVEN.

---

- Assembly instructions: Fifteen A4-sized sheets.
  - Paper craft: Twenty-one A4-sized sheets with 226 parts in all
- 

These instructions apply only to the "DRAGSTAR CLASSIC ELEVEN." These Paper Craft parts are easier to work with when printed out on strong, thick paper (like postcard stock).

■ In creating these Paper Craft models we use 135kg Kent paper stock (0.18mm).

## TO BEGIN

### ■ Tools and materials needed

-Ruler -Scissors - Blade cutter or "Exacto-knife" - Awl or other pointed tool (for making a folding crease) - Felt pen - Pin set - Glue - Hand towel ( for cleaning your fingers) - Dictionary or other heavy book ( to press the papers flat)

### ■ Items of Caution

\*Take care when using sharp or pointed objects or when using bladed cutting tools. Place a heavy sheet of paper under the paper you want to cut.

\*Use glue and other adhesives only in well-ventilated areas.

\*When printing, use a slightly reduced font size as there are many differences in dimensions depending on the type of printer used.

## HOW TO ASSEMBLE

\*Follow the working method and markings carefully.

\*Cut carefully along the outer line with a cutting blade, Exacto-knife or scissors.

### One - point Advice

\*Cut carefully with a cutting blade, Exacto-knife or scissors.

\*For folding parts, first use an awl or other pointed tool to make a light crease along the dotted or solid line. This will make the folds straight. Avoid making strong creases, as this will cause the paper to tear.

\*As an adhesive, white wood glue is recommended. Avoid over-application as this will cause the paper to wrinkle.

\*Before beginning assembly, test adhesive amounts on extra paper.

\*Occasionally, white spots will be apparent on folds and cuts. Use a marker or pencil to fill-in these spots. It is recommended that this be done after each stage of assembly because coloring becomes more difficult once parts are assembled.

## Basic working method and markings

### Solid lines

Fold along these lines. The printed surface should be on the outside of the folded shape.

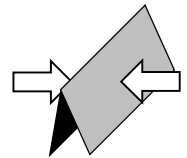

### Broken lines

Fold along these lines. The printed surface should be on the inside of the folded shape.

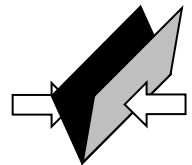

### Dotted line

Cut along these lines

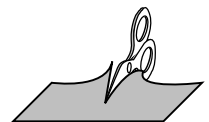

Do not fold or cut the parts marked .

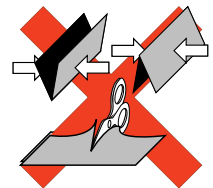

Cut out parts marked with an asterisk (\*).

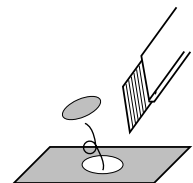

Red dots are the reference positions for gluing surfaces.

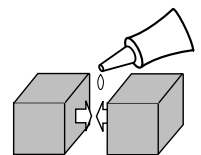

# 1 Assembling the Fuel Tank

First, assemble each component by following the working method and markings. Then, refer to the illustration and photos below to glue the parts together.

Indication of Working Methods

 Fold or Curve  Glue

## Fuel Tank

Sheet A, 5 parts in total

Fold each relevant part according to the assembly symbols.

Please use the ● dots on each component as reference when gluing surfaces.

A-5

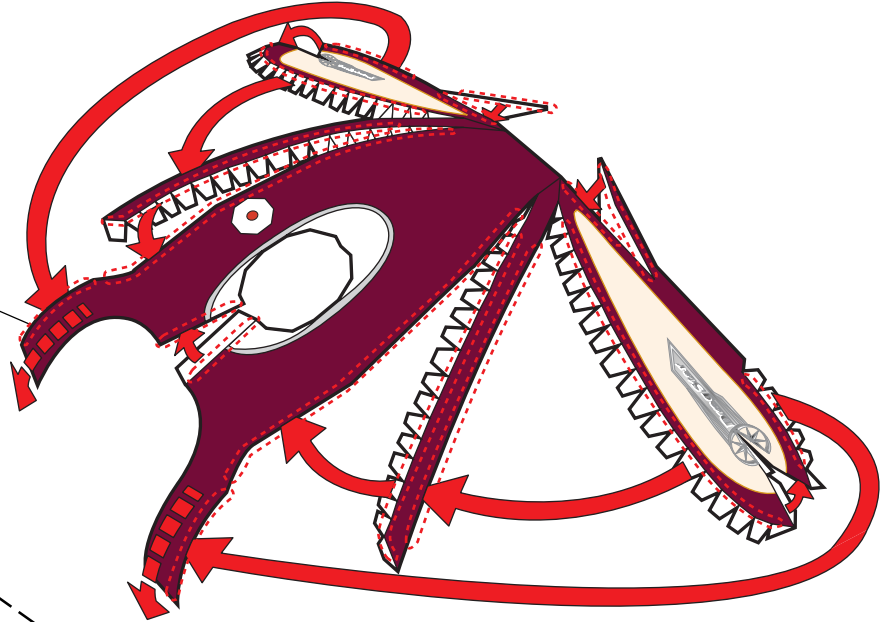

Fold and glue the corresponding tabs (dotted parts) so that they make good symmetrical pairs.

A-4

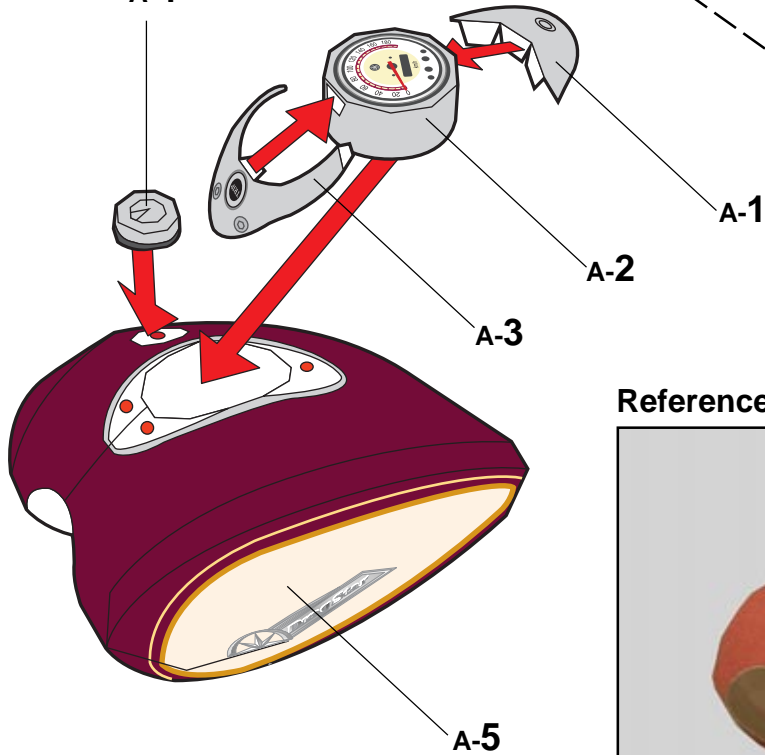

Reference photo



## 2 Assembling the Steering

First, assemble each component by following the working method and markings. Then, refer to the illustration and photos below to glue the parts together.

Indication of Working Methods

 Fold or Curve
  Glue

### Steering

Sheet B, 34 parts in total

Fold each relevant part according to the assembly symbols.

Please use the ● dots on each component as reference when gluing surfaces.

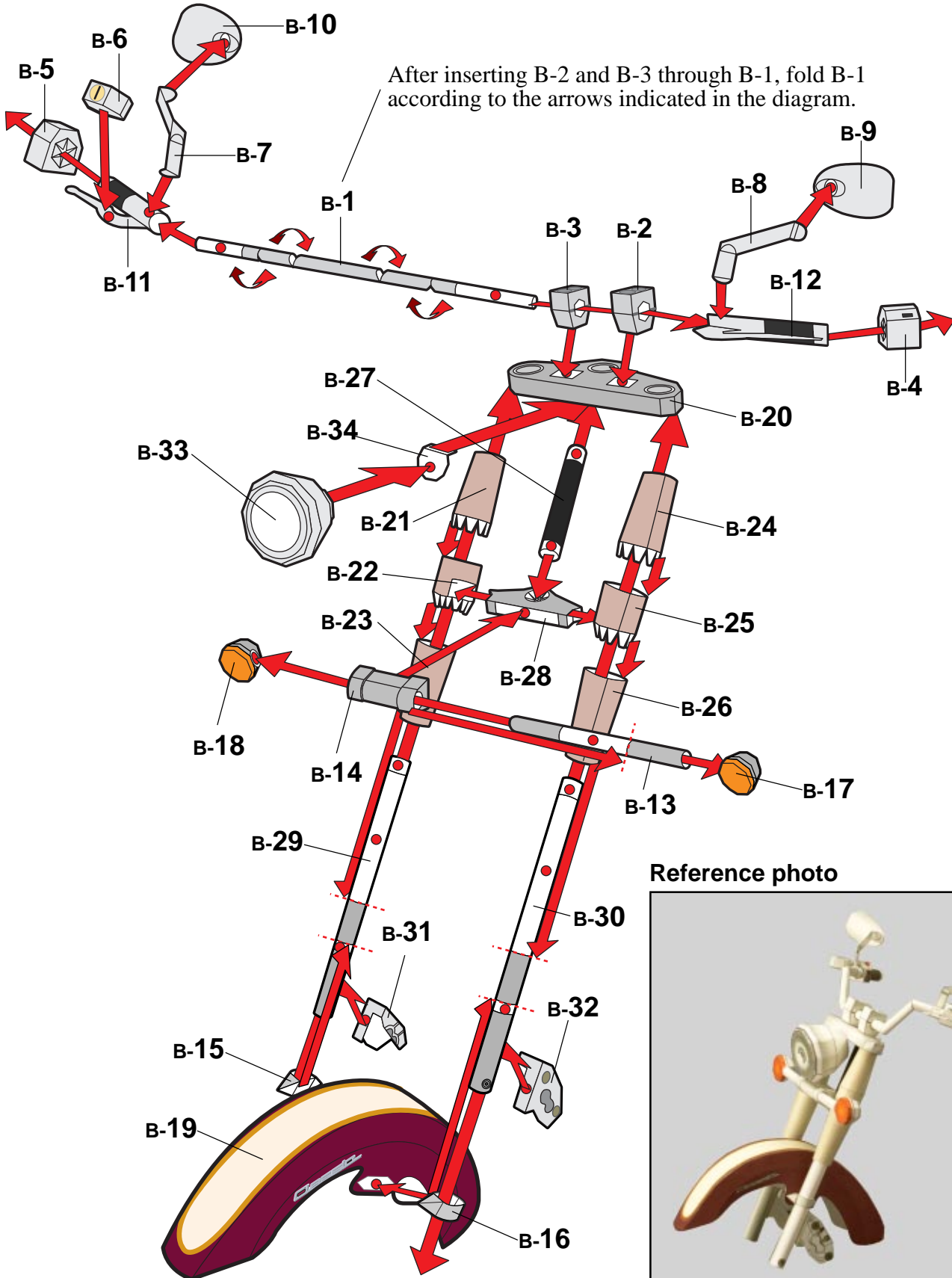

# 3 Assembling the Frame

First, assemble each component by following the working method and markings. Then, refer to the illustration and photos below to glue the parts together.

Indication of Working Methods

 Fold or Curve  Glue

## Frame

Sheet C, 33 parts in total

Fold each relevant part according to the assembly symbols.

Please use the ● dots on each component as reference when gluing surfaces.

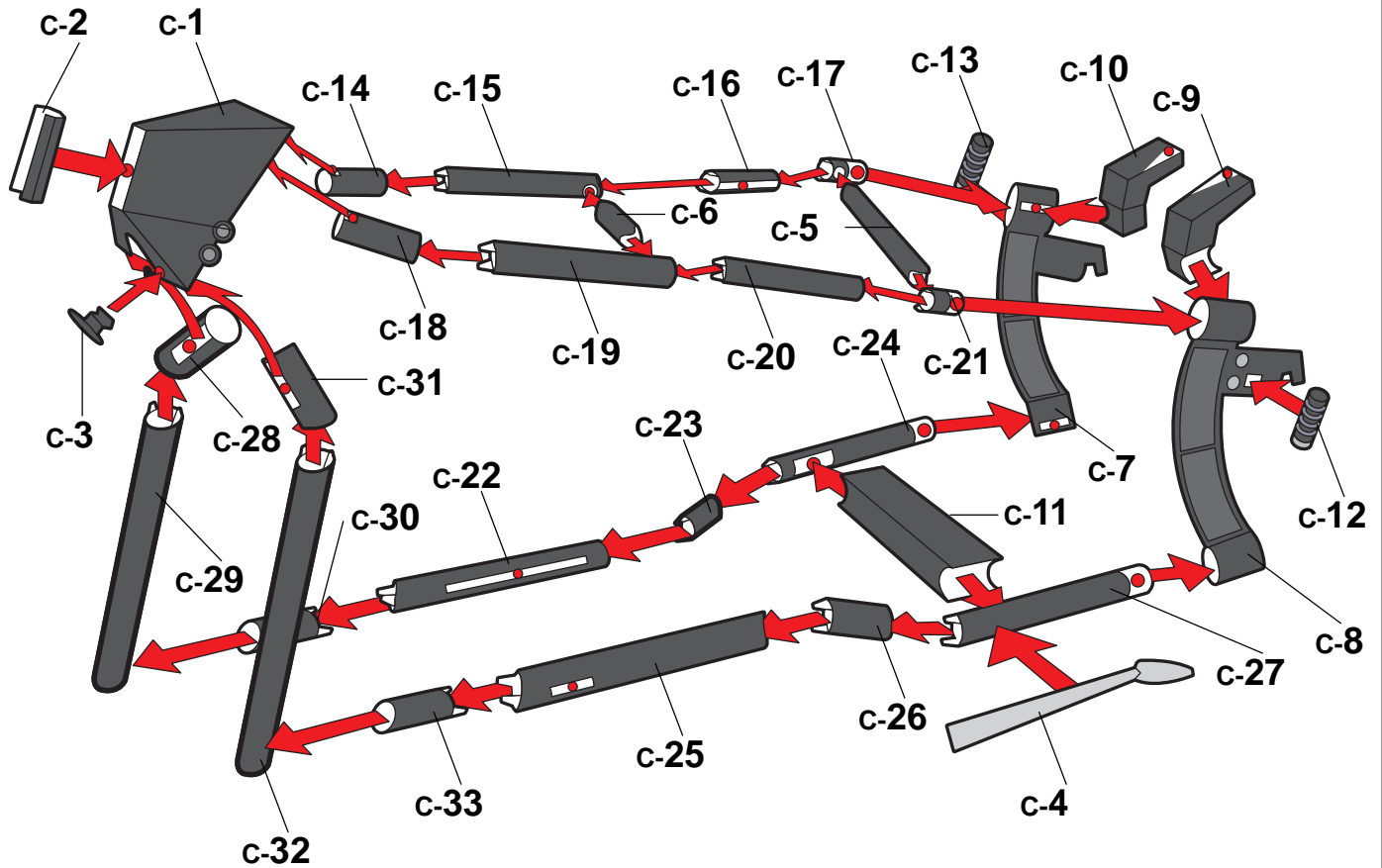

Reference photo



# 4 Assembling the Engine

First, assemble each component by following the working method and markings. Then, refer to the illustration and photos below to glue the parts together.

Indication of Working Methods

 Fold or Curve  Glue

## Engine

Sheet D, 32 parts in total

Fold each relevant part according to the assembly symbols.

Please use the ● dots on each component as reference when gluing surfaces.

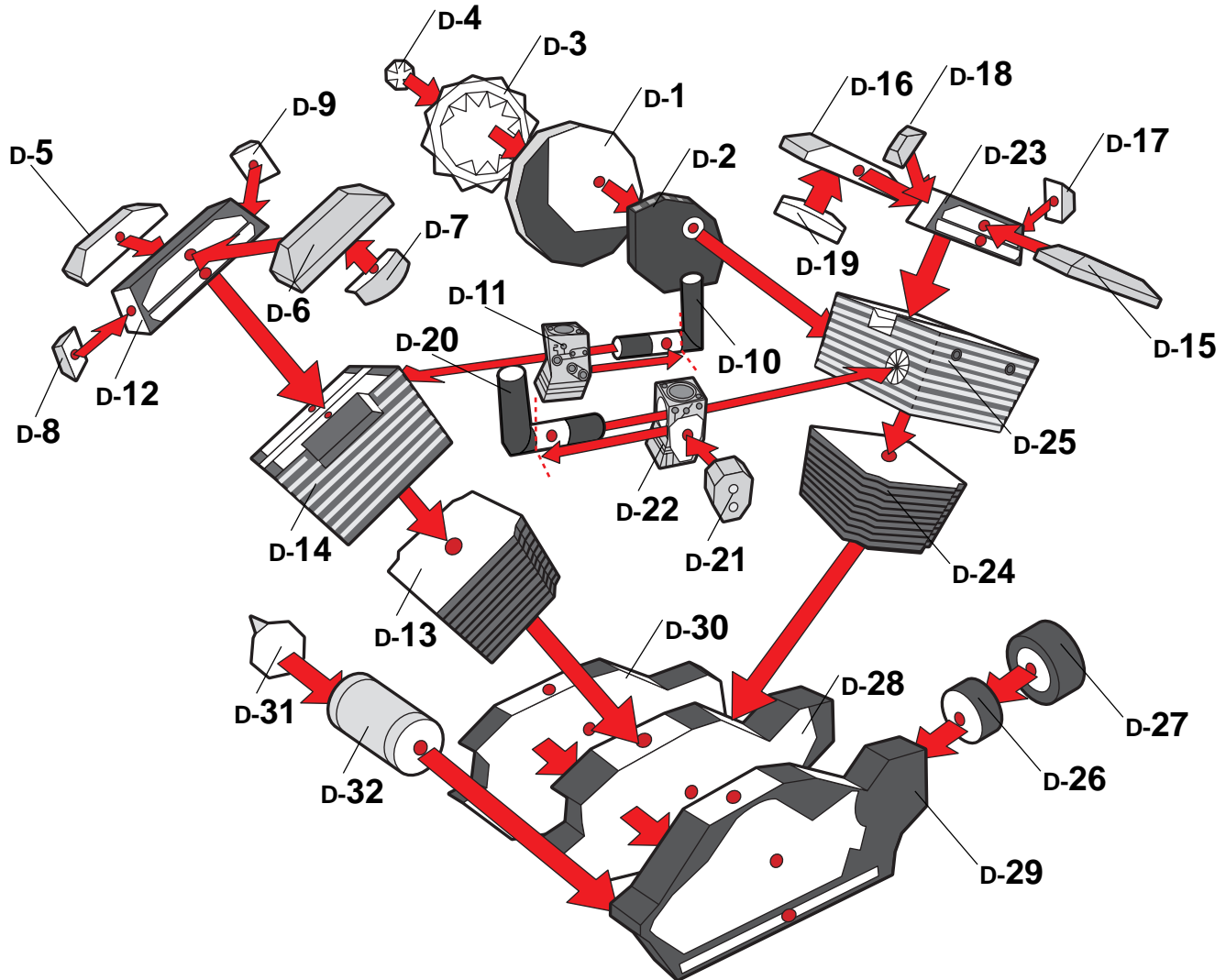

Reference photo

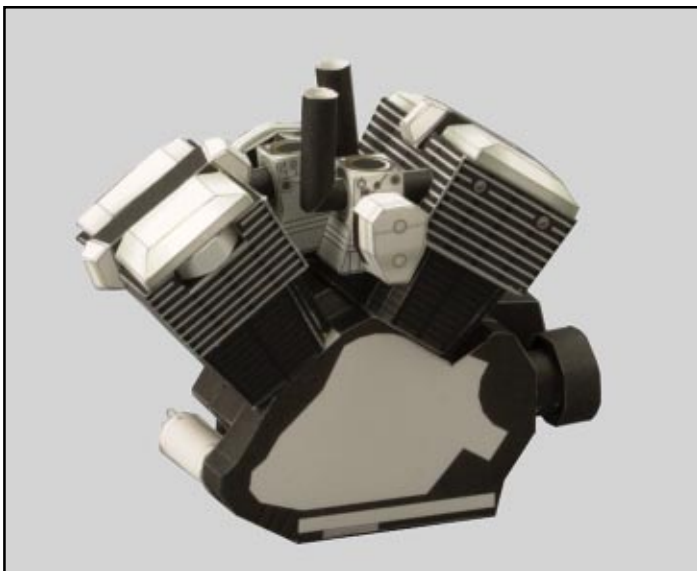

# 5 Assembling the Exhaust Pipes, Footboards

First, assemble each component by following the working method and markings. Then, refer to the illustration and photos below to glue the parts together.

Indication of Working Methods

 Fold or Curve  Glue

## Exhaust Pipes

Sheet E, 17 parts in total

Fold each relevant part according to the assembly symbols.

Please use the ● dots on each component as reference when gluing surfaces.

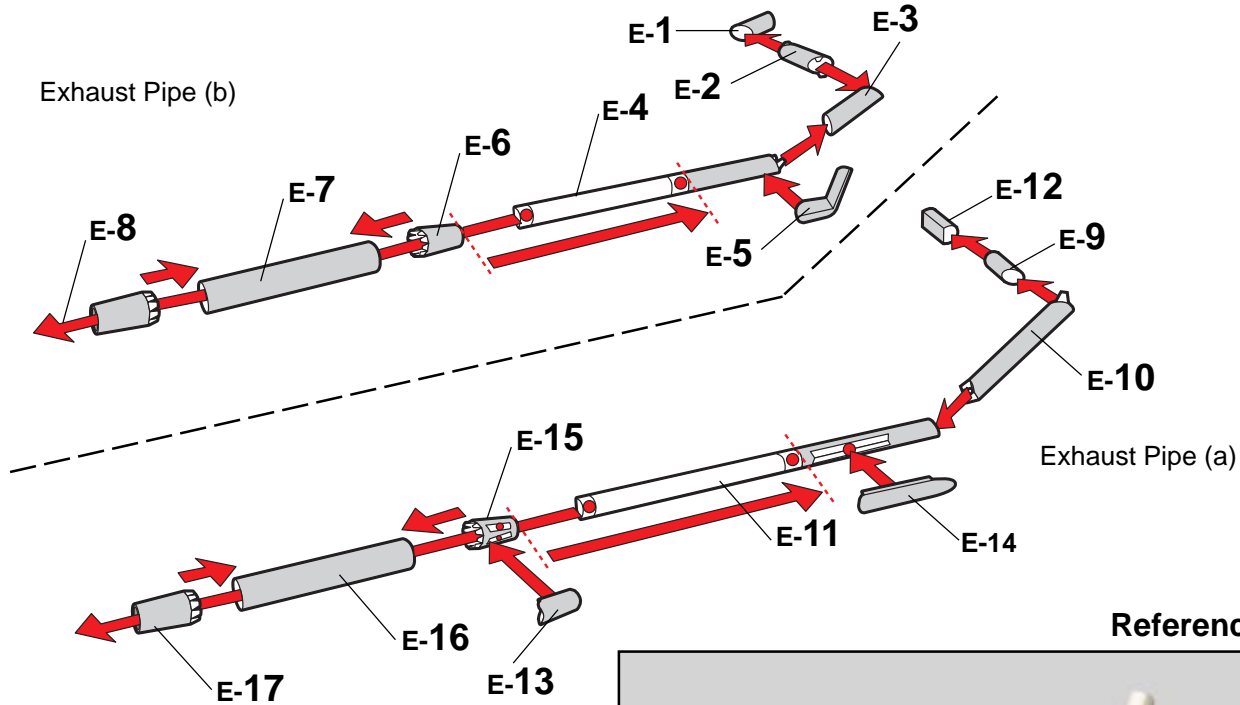

Reference photo

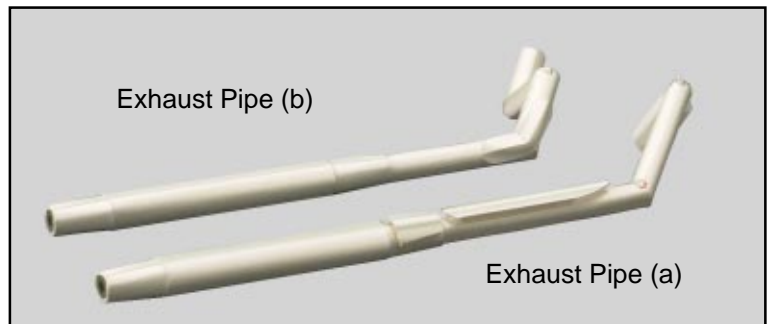

## Footboards

Sheet F, 11 parts in total

Footboard (right)

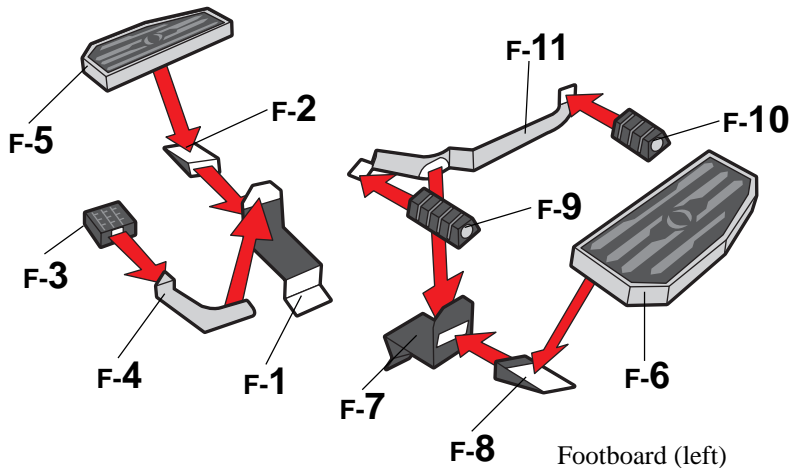

Reference photo

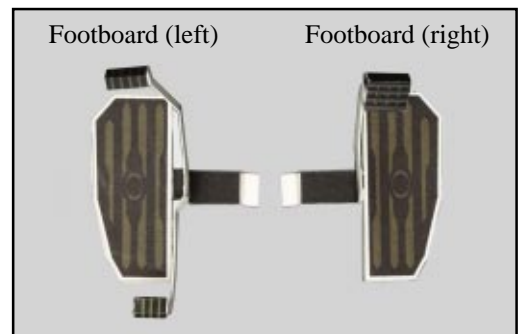

# 6 Assembling the Rear Arm

First, assemble each component by following the working method and markings. Then, refer to the illustration and photos below to glue the parts together.

Indication of Working Methods

 Fold or Curve  Glue

## Rear Arm

Sheet G, 28 parts in total

Fold each relevant part according to the assembly symbols.

Please use the ● dots on each component as reference when gluing surfaces.

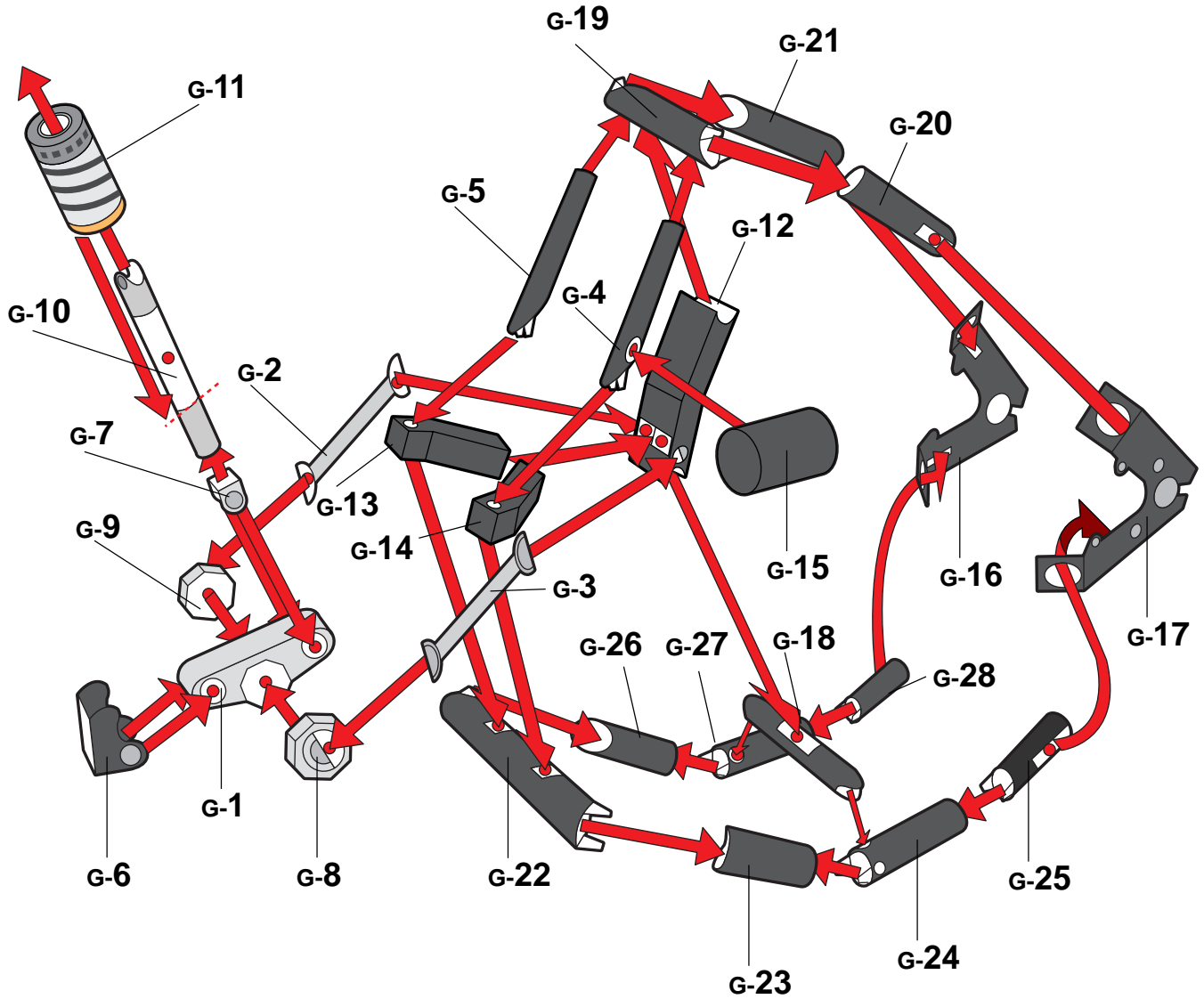

Reference photo





# 7 Assembling the Side Covers

First, assemble each component by following the working method and markings. Then, refer to the illustration and photos below to glue the parts together.

Indication of Working Methods

 Fold or Curve  Glue

## Side Covers

Sheet H, 17 parts in total

Fold each relevant part according to the assembly symbols.

Please use the ● dots on each component as reference when gluing surfaces.

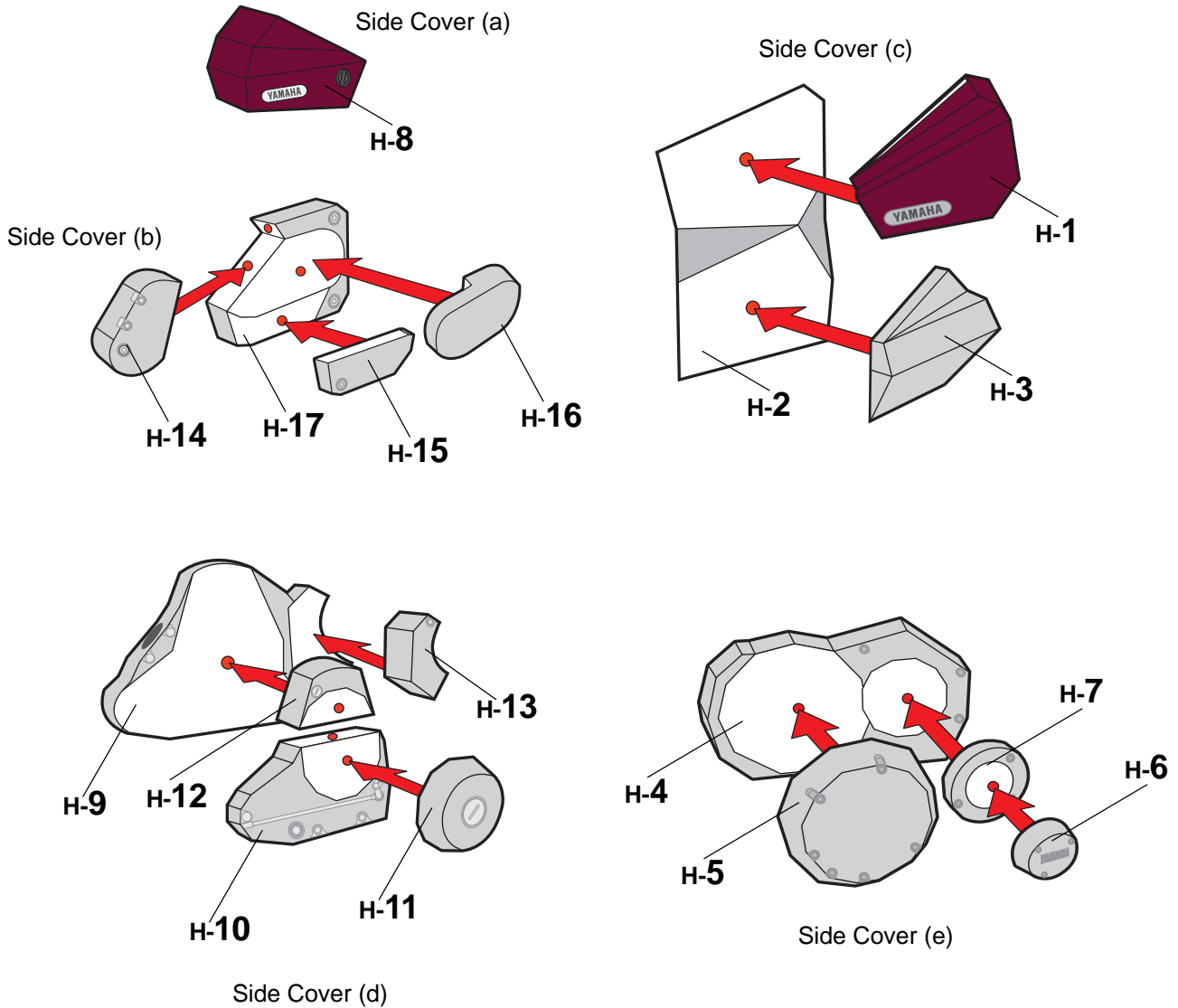

## Reference photo

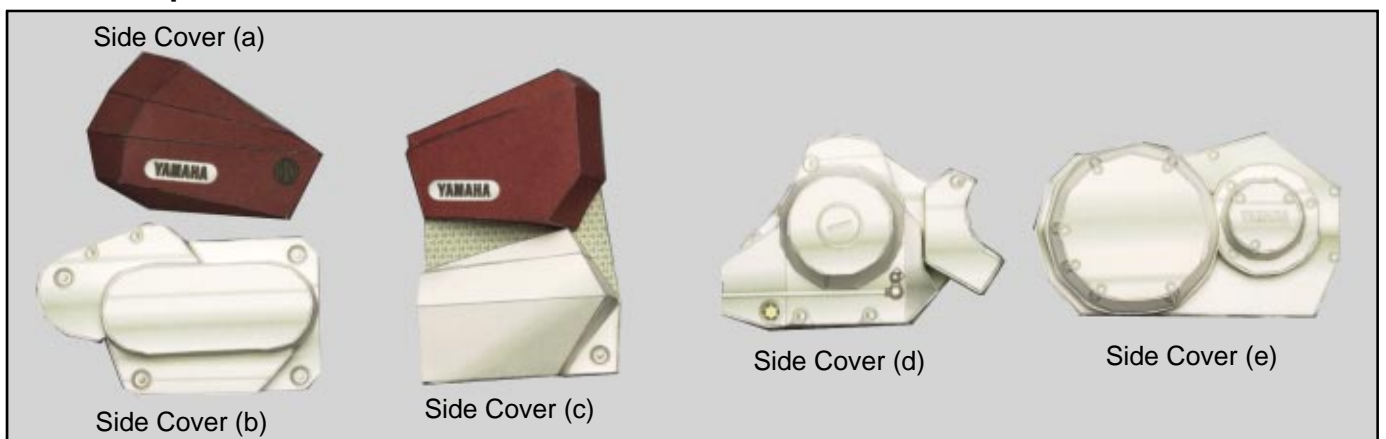

# 8 Assembling the Rear Fender, Seat

First, assemble each component by following the working method and markings. Then, refer to the illustration and photos below to glue the parts together.

Indication of Working Methods

 Fold or Curve  Glue

## Rear Fender

Sheet I, 12 parts in total

Fold each relevant part according to the assembly symbols.

Please use the ● dots on each component as reference when gluing surfaces.

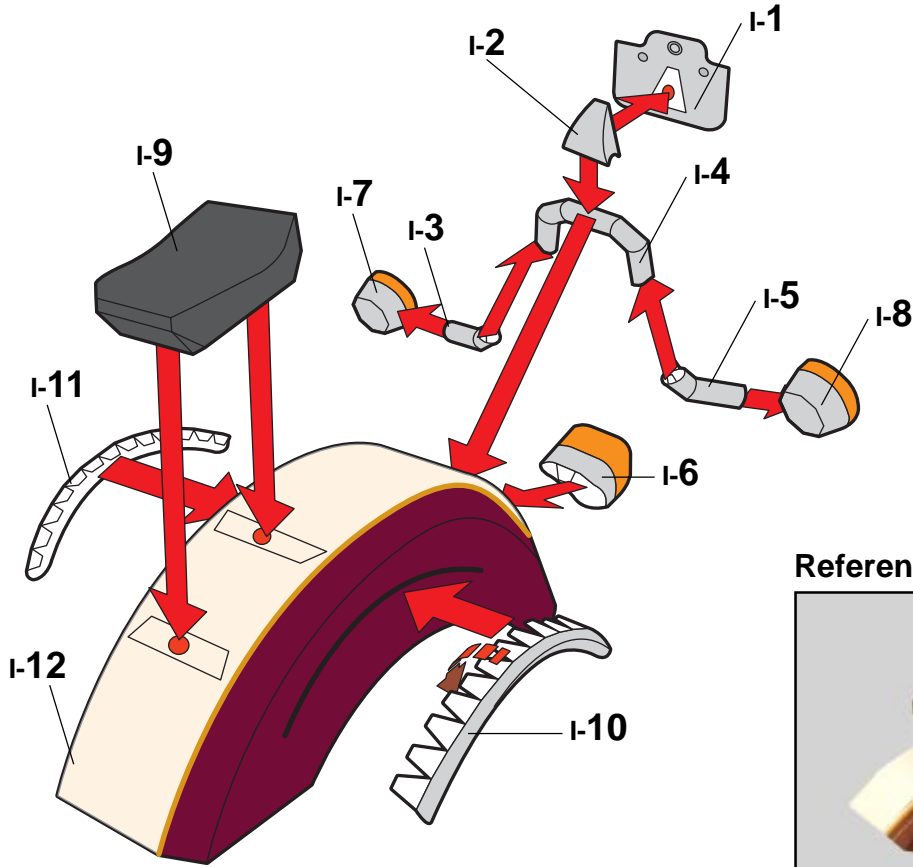

Reference photo

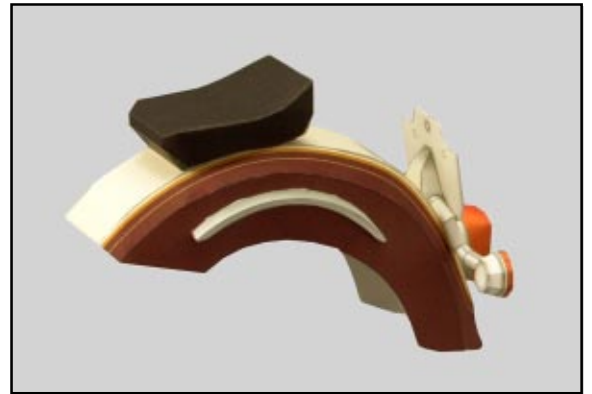

## Seat

Sheet J, 2 parts in total

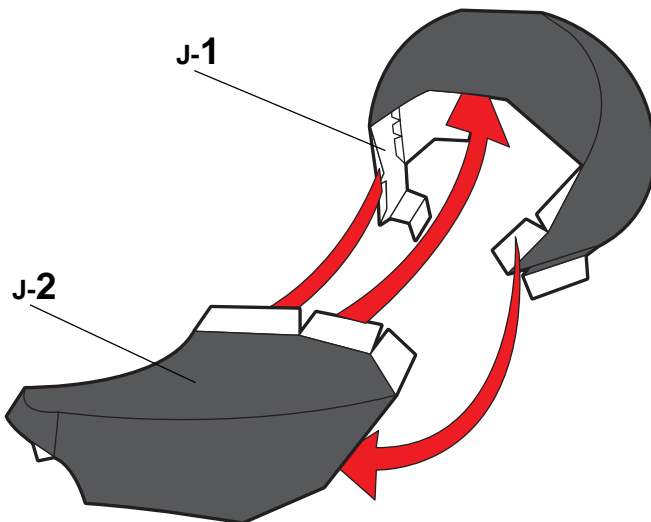

Reference photo



# 9 Assembling the Front Tire

First, assemble each component by following the working method and markings. Then, refer to the illustration and photos below to glue the parts together.

Indication of Working Methods

▄▄▄▄▶ Fold or Curve    ▶ Glue

## Front Tire

Sheet K, 14 parts in total

Fold each relevant part according to the assembly symbols.

Please use the ● dots on each component as reference when gluing surfaces.

\*Glue the completed front wheel to the assembled front tire.

[Front tire]

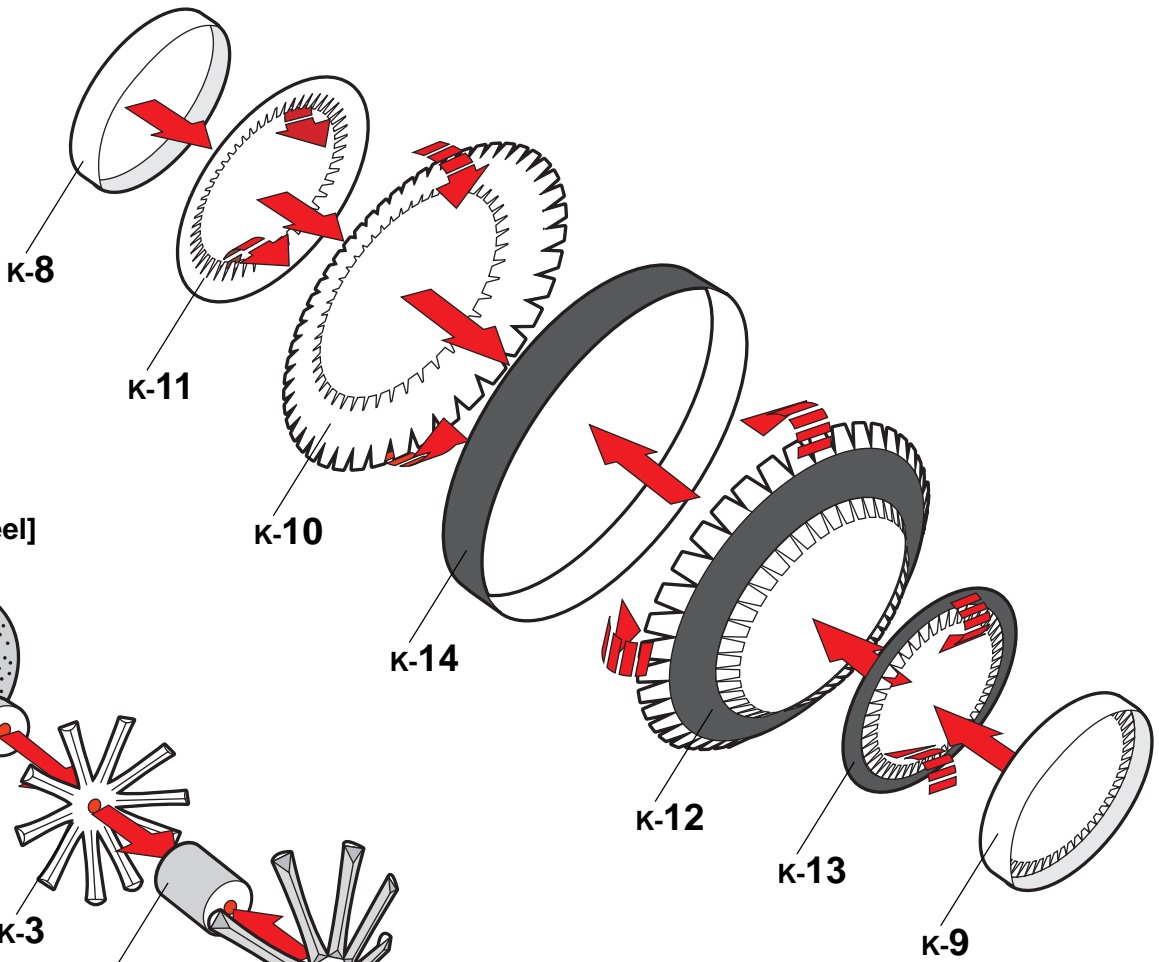

[Front wheel]

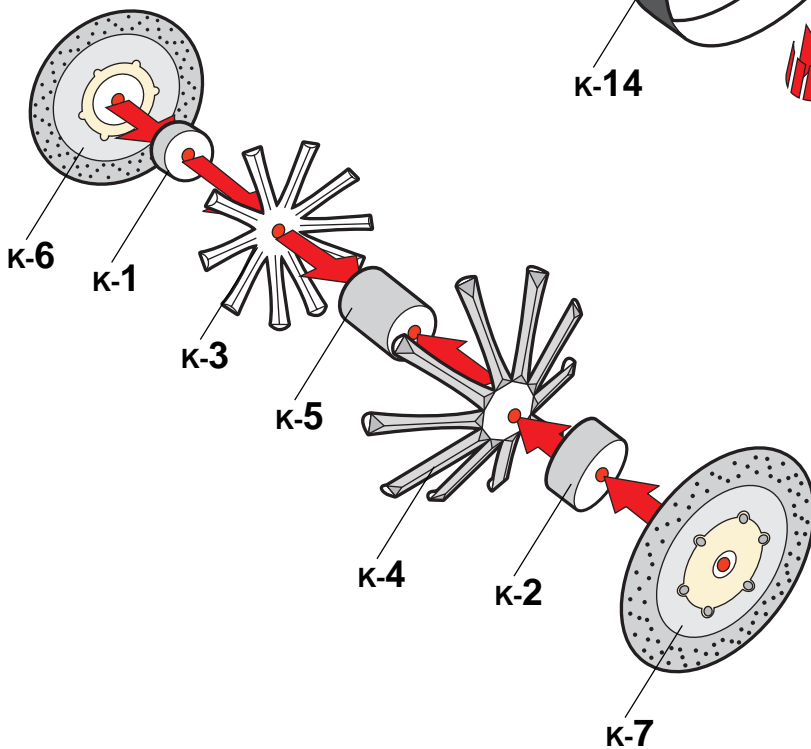

Reference photo



# 10 Assembling the Rear Tire

First, assemble each component by following the working method and markings. Then, refer to the illustration and photos below to glue the parts together.

Indication of Working Methods

 Fold or Curve  Glue

## Rear Tire

Sheet L, 21 parts in total

Fold each relevant part according to the assembly symbols.

Please use the ● dots on each component as reference when gluing surfaces.

\*Glue the completed rear wheel to the assembled rear tire.

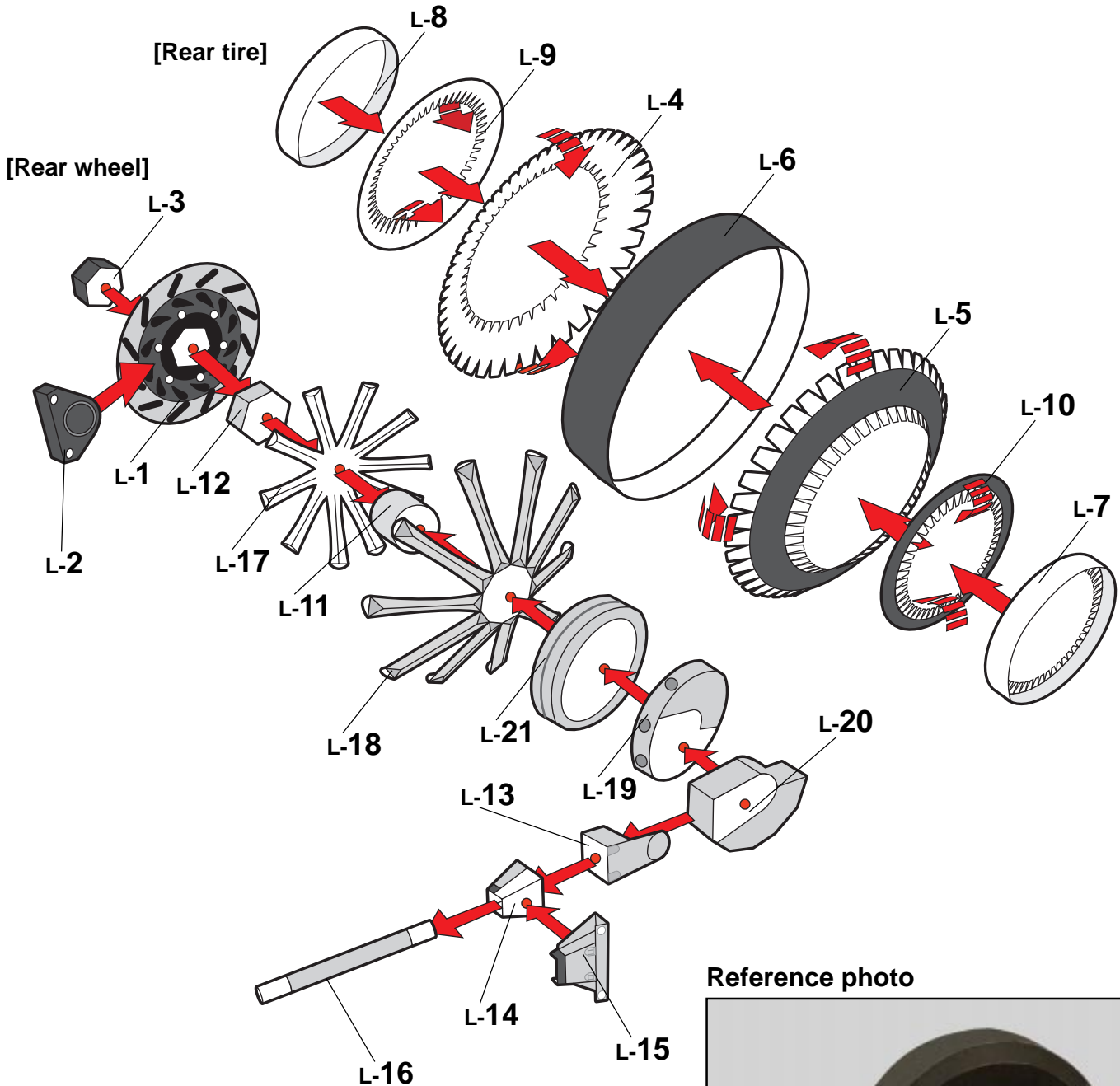

Reference photo

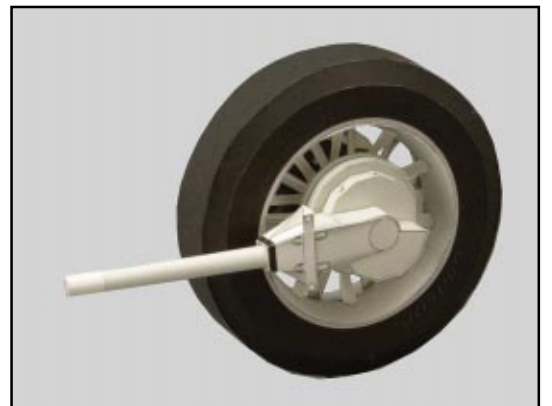

# 11 Finish

Please use the ● dots on each component as reference when gluing surfaces.

## Assembly Instructions

glue the assembled parts in numerical order ① through ⑫ .

- ① Glue the rear arm to the frame.
- ② Glue the rear tire to the rear arm.
- ③ Glue the rear fender to the frame.
- ④ Glue the seat to the frame.
- ⑤ Glue the side covers, d and c, to the engine.
- ⑥ Glue the exhaust pipes, a and b, to the engine.
- ⑦ Glue the part completed in ⑥ to the frame.
- ⑧ Glue side covers, a, b and c, to the frame.
- ⑨ Glue the front tire to the steering.
- ⑩ Glue the steering to the frame.
- ⑪ Glue the fuel tank to the frame.
- ⑫ Complete the assembly by gluing the left and right footboards to each side of the frame.

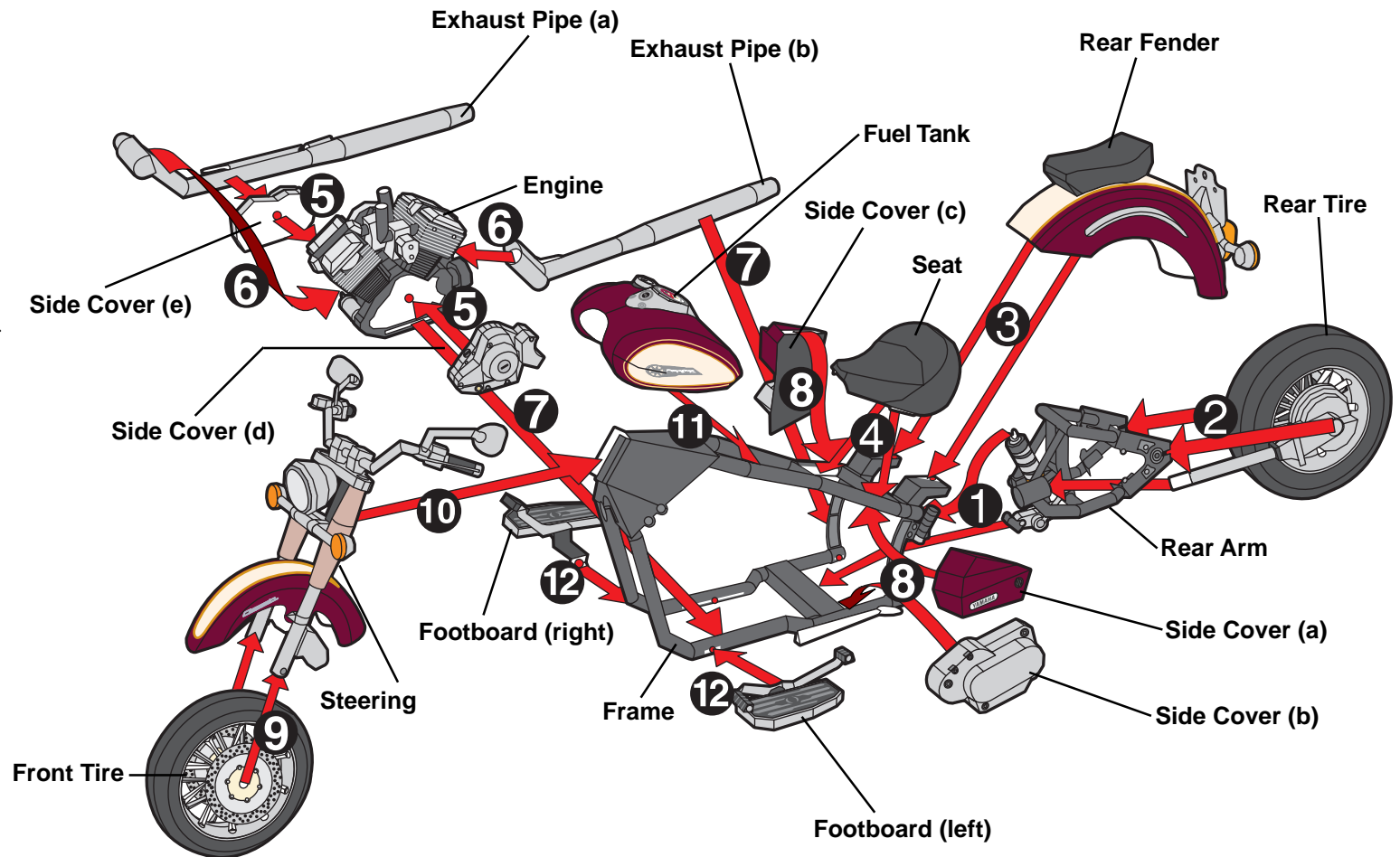

# 12 Assembled Model and the List of Parts

Please refer to the photo below when attaching each component.

**RIGHT**

**FRONT**

**Seat**

- J-1
- J-2

**Side Covers**

- |     |      |      |
|-----|------|------|
| H-1 | H-7  | H-13 |
| H-2 | H-8  | H-14 |
| H-3 | H-9  | H-15 |
| H-4 | H-10 | H-16 |
| H-5 | H-11 | H-17 |
| H-6 | H-12 |      |

**Fuel Tank**

- A-1
- A-2
- A-3
- A-4
- A-5

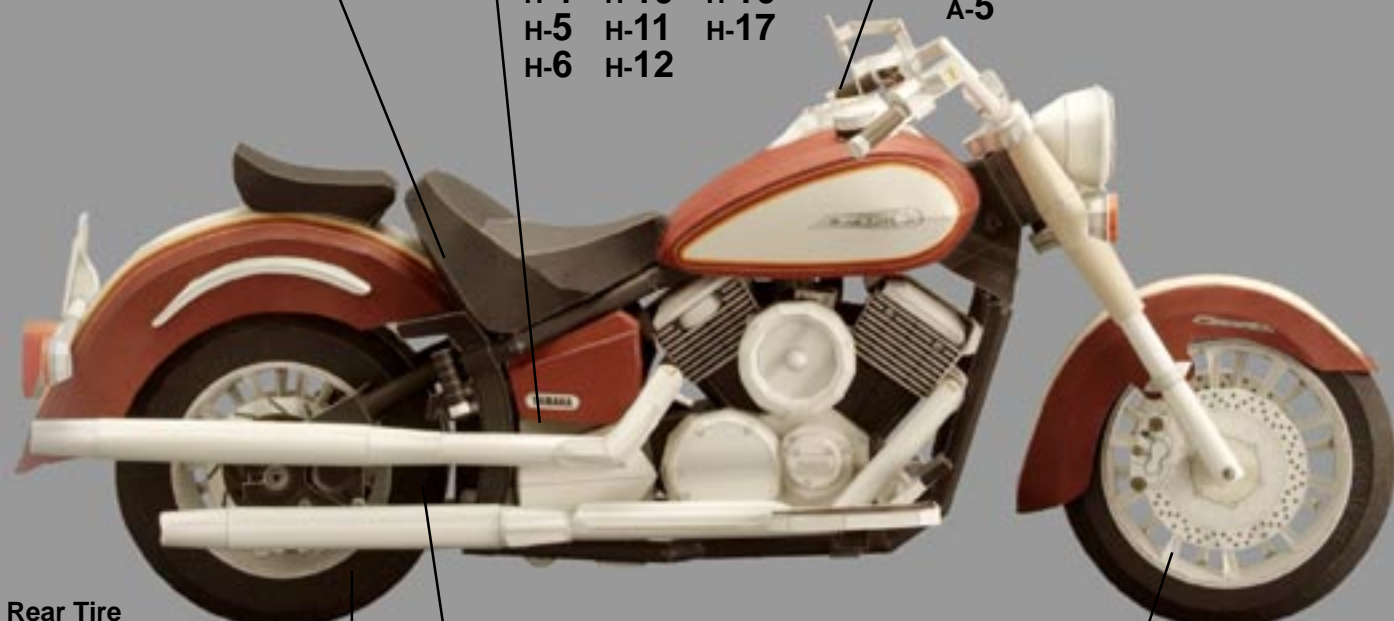

**Rear Tire**

- |     |      |      |      |
|-----|------|------|------|
| L-1 | L-6  | L-11 | L-16 |
| L-2 | L-7  | L-12 | L-17 |
| L-3 | L-8  | L-13 | L-18 |
| L-4 | L-9  | L-14 | L-19 |
| L-5 | L-10 | L-15 | L-20 |
|     |      |      | L-21 |

**Exhaust Pipes**

- |     |      |      |      |
|-----|------|------|------|
| E-1 | E-6  | E-11 | E-16 |
| E-2 | E-7  | E-12 | E-17 |
| E-3 | E-8  | E-13 |      |
| E-4 | E-9  | E-14 |      |
| E-5 | E-10 | E-15 |      |

**Front Tire**

- |     |      |      |
|-----|------|------|
| K-1 | K-6  | K-11 |
| K-2 | K-7  | K-12 |
| K-3 | K-8  | K-13 |
| K-4 | K-9  | K-14 |
| K-5 | K-10 |      |

**Steering**

- |     |      |      |      |      |      |
|-----|------|------|------|------|------|
| B-1 | B-7  | B-13 | B-19 | B-25 | B-31 |
| B-2 | B-8  | B-14 | B-20 | B-26 | B-32 |
| B-3 | B-9  | B-15 | B-21 | B-27 | B-33 |
| B-4 | B-10 | B-16 | B-22 | B-28 | B-34 |
| B-5 | B-11 | B-17 | B-23 | B-29 |      |
| B-6 | B-12 | B-18 | B-24 | B-30 |      |

# 13 Assembled Model and the List of Parts

Please refer to the photo below when attaching each component.

**LEFT**

**REAR**

**Engine**

D-1	D-6	D-11	D-16	D-21	D-26	D-31
D-2	D-7	D-12	D-17	D-22	D-27	D-32
D-3	D-8	D-13	D-18	D-23	D-28	
D-4	D-9	D-14	D-19	D-24	D-29	
D-5	D-10	D-15	D-20	D-25	D-30	

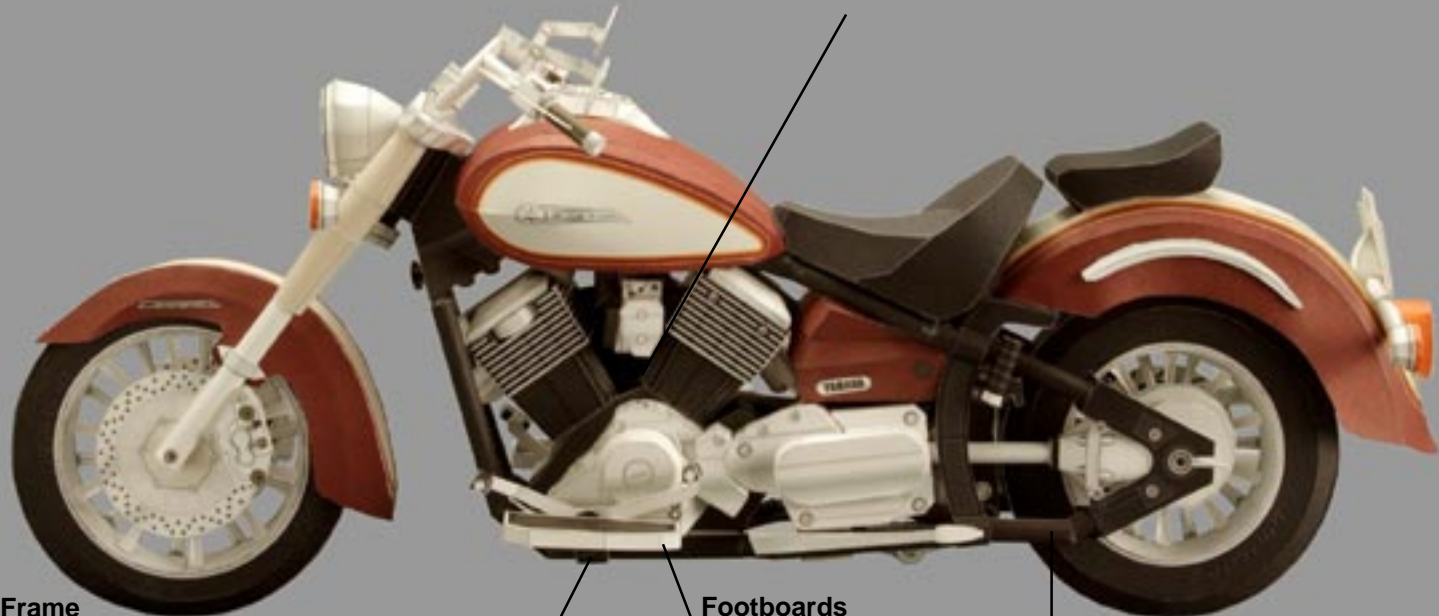

**Frame**

C-1	C-7	C-13	C-20	C-26	C-32
C-2	C-8	C-14	C-21	C-27	C-33
C-3	C-9	C-15	C-22	C-28	
C-4	C-10	C-16	C-23	C-29	
C-5	C-11	C-18	C-24	C-30	
C-6	C-12	C-19	C-25	C-31	

**Footboards**

F-1	F-5	F-9
F-2	F-6	F-10
F-3	F-7	F-11
F-4	F-8	

**Rear Arm**

G-1	G-6	G-11	G-16	G-22	G-27
G-2	G-7	G-12	G-18	G-23	G-28
G-3	G-8	G-13	G-19	G-24	
G-4	G-9	G-14	G-20	G-25	
G-5	G-10	G-15	G-21	G-26	

**Rear Fender**

I-1	I-6	I-11
I-2	I-7	I-12
I-3	I-8	
I-4	I-9	
I-5	I-10	